

## PRZEWODY KOMINOWE TYPU DWWk

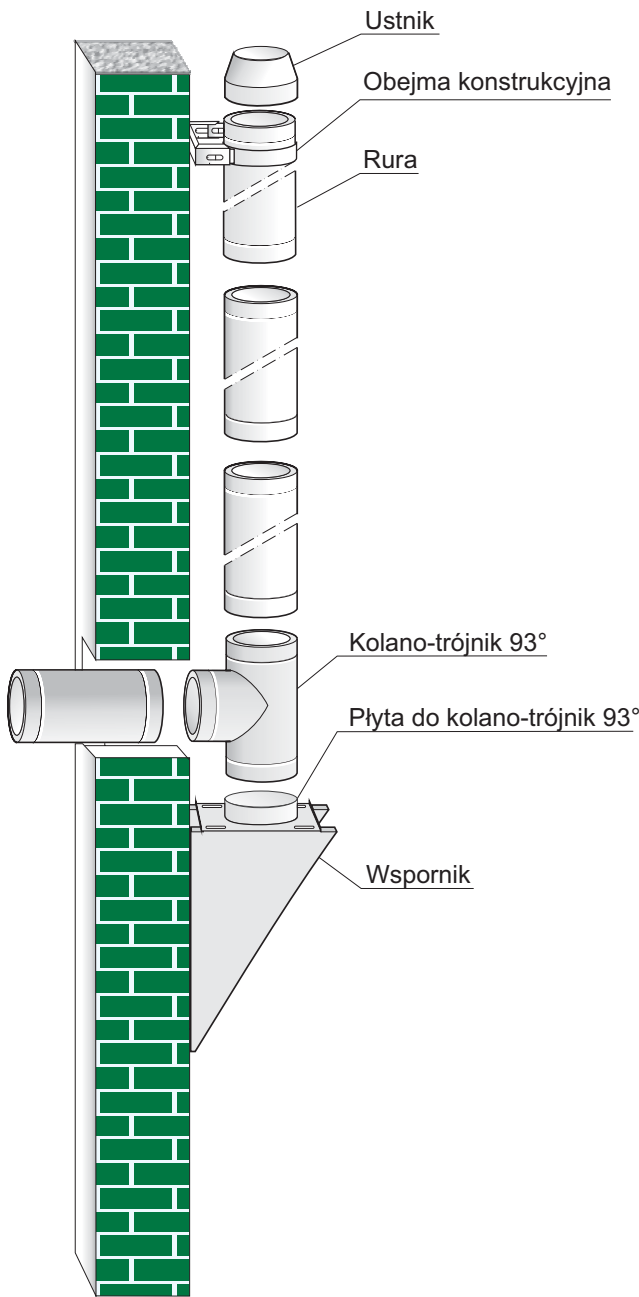

### PRZEZNACZENIE:

odprowadzenie spalin z kotłów kondensacyjnych opalanych gazem lub olejem opałowym o maksymalnej temperaturze spalin 120°C

### BUDOWA RUR I KSZTAŁTEK:

elementy spalinowe izolowane wełną mineralną o grubości 30 ÷ 50 mm

### ZAKRES ŚREDNIC:

dwuścienne izolowane 120/200 ÷ 500/600 mm

### PALIWO:

gaz lub olej opałowy

### GATUNEK I GRUBOŚĆ MATERIAŁU:

stal nierdzewna i kwasoodporna 1.4301 /opcjonalnie 1.4404, 1.4521/ o grubości 0,5÷0,8 mm

### ODPORNOŚĆ NA KOROZJĘ:

Vm/V2

### ODPORNOŚĆ NA POŻAR SADZY:

nieodporny

### ODLEGŁOŚĆ OD MATERIAŁÓW PALNYCH:

50 mm

### KLASA TEMPERATURY:

T120 - 120°C (dotyczy temperatury spalin)

### KLASA CIŚNIENIA:

klasa P1 - 200 Pa (spalinowy)

### SPOSÓB PRACY KOMINA:

nadciśnieniowy (szczelność połączeń zapewniają uszczelki EPDM typ EP 1692 umieszczone w połączeniach kielichowych)

### ODPORNOŚĆ NA DZIAŁANIE KONDENSATU:

W/D

## USTNIK

351

d	D	INDEKS
120	200	3511200005
130	200	3511300005
140	200	3511400005
150	225	3511500005
160	225	3511600005
180	250	3511800005
200	300	3512000005
225	300	3512200005
250	350	3512500005
300	400	3513000005
350	450	3513500005
400	500	3514000005
450	550	3514500005
500	600	3515000005

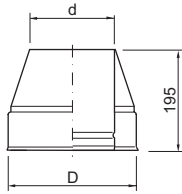

## USTNIK POD PARASOL

352

d	D	INDEKS
120	200	3521200005
130	200	3521300005
140	200	3521400005
150	225	3521500005
160	225	3521600005
180	250	3521800005
200	300	3522000005
225	300	3522200005
250	350	3522500005
300	400	3523000005
350	450	3523500005
400	500	3524000005
450	550	3524500005
500	600	3525000005

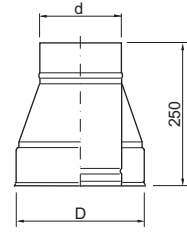

## RURA

353, 354, 355, 356

INDEKS					
d	D	L 1000	L 500	L 330	L 250
120	200	3531200005	3541200005	3551200005	3561200005
130	200	3531300005	3541300005	3551300005	3561300005
140	200	3531400005	3541400005	3551400005	3561400005
150	225	3531500005	3541500005	3551500005	3561500005
160	225	3531600005	3541600005	3551600005	3561600005
180	250	3531800005	3541800005	3551800005	3561800005
200	300	3532000005	3542000005	3552000005	3562000005
225	300	3532200005	3542200005	3552200005	3562200005
250	350	3532500005	3542500005	3552500005	3562500005
300	400	3533000005	3543000005	3553000005	3563000005
350	450	3533500005	3543500005	3553500005	3563500005
400	500	3534000005	3544000005	3554000005	3564000005
450	550	3534500005	3544500005	3554500005	3564500005
500	600	3535000005	3545000005	3555000005	3565000005

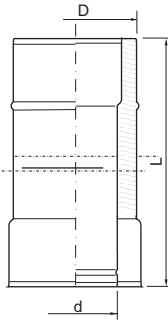

## TRÓJNIK 93°

357

d	D	L	INDEKS
120	200	400	3571200005
130	200	400	3571300005
140	200	400	3571400005
150	225	450	3571500005
160	225	450	3571600005
180	250	450	3571800005
200	300	500	3572000005
225	300	500	3572200005
250	350	550	3572500005
300	400	600	3573000005
350	450	650	3573500005
400	500	700	3574000005
450	550	750	3574500005
500	600	800	3575000005

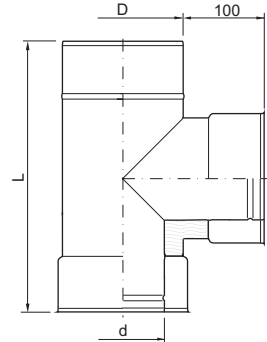

## TRÓJNIK 45°

358

d	D	A	L	INDEKS
120	200	350	500	3581200005
130	200	350	500	3581300005
140	200	350	500	3581400005
150	225	400	570	3581500005
160	225	400	570	3581600005
180	250	410	570	3581800005
200	300	500	700	3582000005
225	300	500	700	3582200005
250	350	550	800	3582500005
300	400	600	800	3583000005
350	450	680	900	3583500005
400	500	780	1000	3584000005
450	550	780	1000	3584500005
500	600	860	1100	3585000005

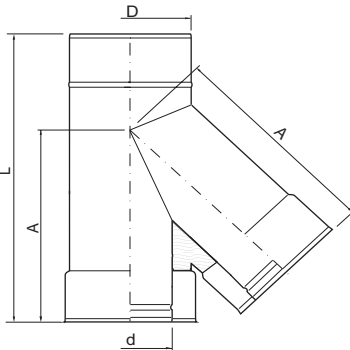

## WYCZYSTKA OKRĄGŁA

359

d1	d	D	INDEKS
120	120	200	3591200005
130	200	200	3591300005
140	200	200	3591400005
150	225	200	3591500005
160	225	200	3591600005
180	250	200	3591800005
200	300	200	3592000005
225	300	200	3592200005
250	350	200	3592500005
300	400	200	3593000005
350	450	200	3593500005
400	500	200	3594000005
450	550	200	3594500005
500	600	200	3595000005

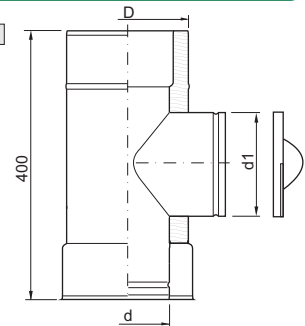

## ODSKRAPLACZ

360

d	D	A	INDEKS
120	200	300	3601200005
130	200	300	3601300005
140	200	300	3601400005
150	225	300	3601500005
160	225	300	3601600005
180	250	350	3601800005
200	300	400	3602000005
225	300	400	3602200005
250	350	450	3602500005
300	400	500	3603000005
350	450	550	3603500005
400	500	600	3604000005
450	550	650	3604500005
500	600	700	3605000005

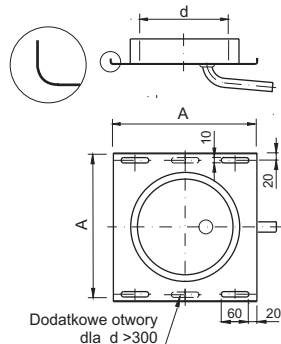

## KOLANO 15°

361

d	D	A	INDEKS
120	200	140	3611200005
130	200	140	3611300005
140	200	140	3611400005
150	225	160	3611500005
160	225	160	3611600005
180	250	155	3611800005
200	300	195	3612000005
225	300	195	3612200005
250	350	205	3612500005
300	400	215	3613000005
350	450	240	3613500005
400	500	240	3614000005
450	550	245	3614500005
500	600	245	3615000005

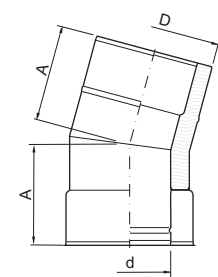

## KOLANO 30°

362

d	D	A	INDEKS
120	200	140	3621200005
130	200	140	3621300005
140	200	140	3621400005
150	225	160	3621500005
160	225	160	3621600005
180	250	155	3621800005
200	300	195	3622000005
225	300	195	3622200005
250	350	205	3622500005
300	400	215	3623000005
350	450	240	3623500005
400	500	240	3624000005
450	550	245	3624500005
500	600	245	3625000005

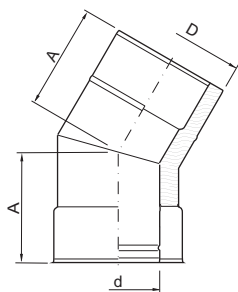

## KOLANO 45°

363

d	D	A	INDEKS
120	200	125	3631200005
130	200	125	3631300005
140	200	125	3631400005
150	225	130	3631500005
160	225	130	3631600005
180	250	135	3631800005
200	300	160	3632000005
225	300	160	3632200005
250	350	170	3632500005
300	400	180	3633000005
350	450	190	3633500005
400	500	200	3634000005
450	550	210	3634500005
500	600	220	3635000005

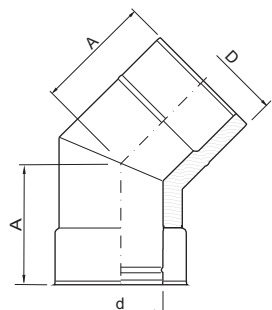

KOLANO 93°

364

d	D	A	INDEKS
120	200	155	3641200005
130	200	155	3641300005
140	200	155	3641400005
150	225	165	3641500005
160	225	165	3641600005
180	250	180	3641800005
200	300	220	3642000005
225	300	220	3642200005
250	350	250	3642500005
300	400	280	3643000005
350	450	305	3643500005
400	500	325	3644000005
450	550	355	3644500005
500	600	380	3645000005

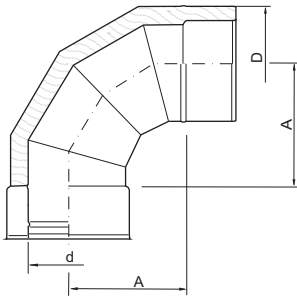

KOLANO Z WYCZYSTKĄ OKRĄGLĄ

365

d1	d	D	A	INDEKS
120	120	200	200	3651200005
130	200	200	200	3651300005
140	200	200	200	3651400005
150	225	200	200	3651500005
160	225	200	200	3651600005
180	250	205	205	3651800005
200	300	215	215	3652000005
225	300	215	215	3652200005
250	350	255	255	3652500005
300	400	295	295	3653000005
350	450	300	300	3653500005
400	500	340	340	3654000005
450	550	360	360	3654500005
500	600	390	390	3655000005

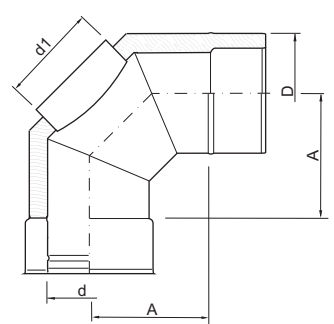

PODPORA PRZEJŚCIOWA

366

d	D	A	INDEKS
120	200	300	3661200005
130	200	300	3661300005
140	200	300	3661400005
150	225	300	3661500005
160	225	300	3661600005
180	250	D+100	3661800005
200	300	D+100	3662000005
225	300	D+100	3662200005
250	350	D+100	3662500005
300	400	D+100	3663000005
350	450	D+100	3663500005
400	500	D+100	3664000005
450	550	D+100	3664500005
500	600	D+100	3665000005

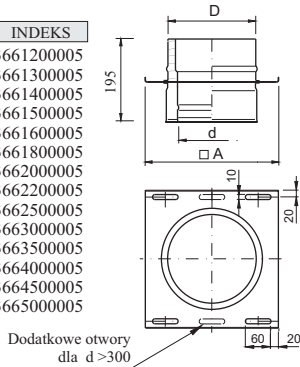

TELESKOP

367

d	D	INDEKS
120	200	3671200005
130	200	3671300005
140	200	3671400005
150	225	3671500005
160	225	3671600005
180	250	3671800005
200	300	3672000005
225	300	3672200005
250	350	3672500005
300	400	3673000005
350	450	3673500005
400	500	3674000005
450	550	3674500005
500	600	3675000005

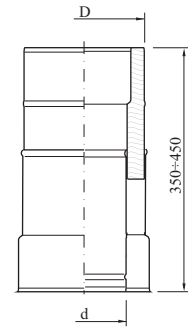

KRÓCIEC POMIAROWY 25

368

d	D	INDEKS
120	200	3681200005
130	200	3681300005
140	200	3681400005
150	225	3681500005
160	225	3681600005
180	250	3681800005
200	300	3682000005
225	300	3682200005
250	350	3682500005
300	400	3683000005
350	450	3683500005
400	500	3684000005
450	550	3684500005
500	600	3685000005

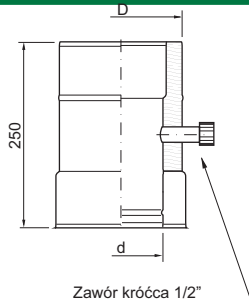

KRÓCIEC POMIAROWY 64

369

d	D	INDEKS
120	200	3691200005
130	200	3691300005
140	200	3691400005
150	225	3691500005
160	225	3691600005
180	250	3691800005
200	300	3692000005
225	300	3692200005
250	350	3692500005
300	400	3693000005
350	450	3693500005
400	500	3694000005
450	550	3694500005
500	600	3695000005

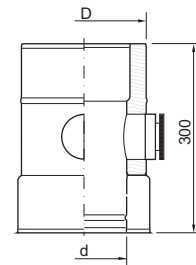

REDUKCJA

370

d	D	INDEKS
120	200	370120xyz5
130	200	370130xyz5
140	200	370140xyz5
150	225	370150xyz5
160	225	370160xyz5
180	250	370180xyz5
200	300	370200xyz5
225	300	370225xyz5
250	350	370250xyz5
300	400	370300xyz5
350	450	370350xyz5
400	500	370400xyz5
450	550	370450xyz5
500	600	370500xyz5

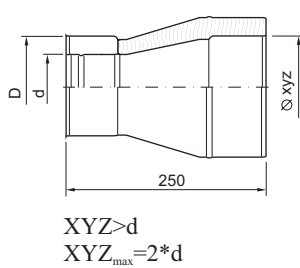

REDUKCJA ODWROTNA

371

d	D	INDEKS
120	200	371120xyz5
130	200	371130xyz5
140	200	371140xyz5
150	225	371150xyz5
160	225	371160xyz5
180	250	371180xyz5
200	300	371200xyz5
225	300	371225xyz5
250	350	371250xyz5
300	400	371300xyz5
350	450	371350xyz5
400	500	371400xyz5
450	550	371450xyz5
500	600	371500xyz5

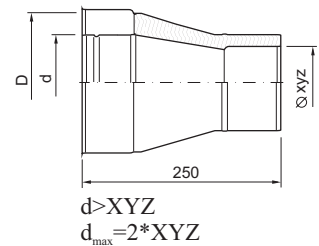

ZŁĄCZKA DWUKIELICHOWA

372

d	D	INDEKS
120	200	3721200005
130	200	3721300005
140	200	3721400005
150	225	3721500005
160	225	3721600005
180	250	3721800005
200	300	3722000005
225	300	3722200005
250	350	3722500005
300	400	3723000005
350	450	3723500005
400	500	3724000005
450	550	3724500005
500	600	3725000005

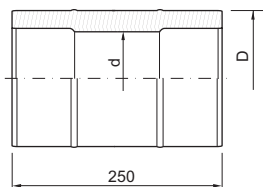

ZŁĄCZKA DWUNYPILOWA

373

d	D	INDEKS
120	200	3731200005
130	200	3731300005
140	200	3731400005
150	225	3731500005
160	225	3731600005
180	250	3731800005
200	300	3732000005
225	300	3732200005
250	350	3732500005
300	400	3733000005
350	450	3733500005
400	500	3734000005
450	550	3734500005
500	600	3735000005

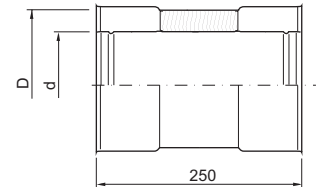

**ZAKOŃCZENIE NUPEL - NYPEL**
**374**

d	D	INDEKS
120	200	3741200005
130	200	3741300005
140	200	3741400005
150	225	3741500005
160	225	3741600005
180	250	3741800005
200	300	3742000005
225	300	3742200005
250	350	3742500005
300	400	3743000005
350	450	3743500005
400	500	3744000005
450	550	3744500005
500	600	3745000005

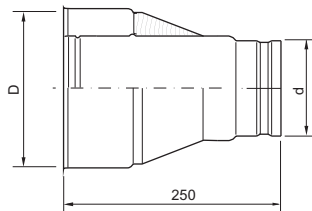
**ZAKOŃCZENIE KIELICH - KIELICH**
**375**

d	D	INDEKS
120	200	3751200005
130	200	3751300005
140	200	3751400005
150	225	3751500005
160	225	3751600005
180	250	3751800005
200	300	3752000005
225	300	3752200005
250	350	3752500005
300	400	3753000005
350	450	3753500005
400	500	3754000005
450	550	3754500005
500	600	3755000005

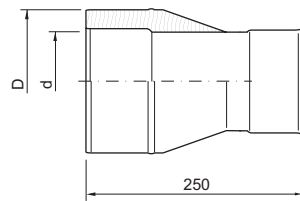
**PRZEDŁUŻKA DO KOMINA**
**376**

d	D	A	L	INDEKS
120	200	320	1280	3761200005
130	200	320	1280	3761300005
140	200	320	1280	3761400005
150	225	320	1280	3761500005
160	225	320	1280	3761600005
180	250	400	1280	3761800005
200	300	400	1280	3762000005
225	300	400	1280	3762200005
250	350	450	1280	3762500005

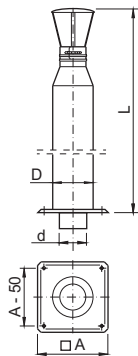

Dla L=1280 indeks jest np. 376 120 0005  
a dla L=780 indeks jest 376 120 1005

**ZAKOŃCZENIE NYPEL - KIELICH**
**377**

d	D	INDEKS
120	200	3771200005
130	200	3771300005
140	200	3771400005
150	225	3771500005
160	225	3771600005
180	250	3771800005
200	300	3772000005
225	300	3772200005
250	350	3772500005
300	400	3773000005
350	450	3773500005
400	500	3774000005
450	550	3774500005
500	600	3775000005

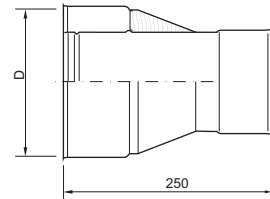
**ZAKOŃCZENIE KIELICH - NYPEL**
**378**

d	D	INDEKS
120	200	3781200005
130	200	3781300005
140	200	3781400005
150	225	3781500005
160	225	3781600005
180	250	3781800005
200	300	3782000005
225	300	3782200005
250	350	3782500005
300	400	3783000005
350	450	3783500005
400	500	3784000005
450	550	3784500005
500	600	3785000005

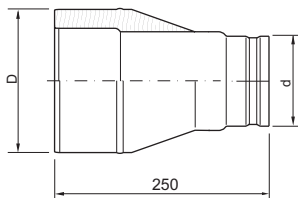
**ODPŁYW KONDENSATU**
**379**

d	D	INDEKS
120	200	3791200005
130	200	3791300005
140	200	3791400005
150	225	3791500005
160	225	3791600005
180	250	3791800005
200	300	3792000005
225	300	3792200005
250	350	3792500005
300	400	3793000005
350	450	3793500005
400	500	3794000005
450	550	3794500005
500	600	3795000005

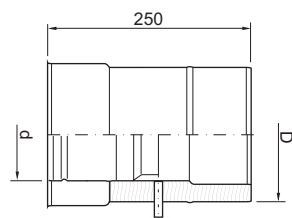
**RURA DYSTANSOWA**
**380**

d	D	INDEKS	
		L=500	L=1000
120	200	3801200005	3801201005
130	200	3801300005	3801301005
140	200	3801400005	3801401005
150	225	3801500005	3801501005
160	225	3801600005	3801601005
180	250	3801800005	3801801005
200	300	3802000005	3802001005
225	300	3802200005	3802201005
250	350	3802500005	3802501005
300	400	3803000005	3803001005
350	450	3803500005	3803501005
400	500	3804000005	3804001005
450	550	3804500005	3804501005
500	600	3805000005	3805001005

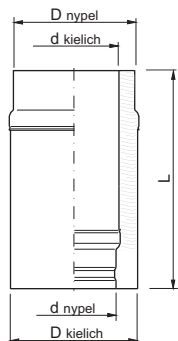

\* - długość dopasować przycinając odpowiednio rurę wew. i zew.

**TRÓJNIK REDUKCYJNY 93°**
**382**

d	D	d1	L	INDEKS
120	200	400	382120xyz5	
130	200	400	382130xyz5	
140	200	400	382140xyz5	
150	225	450	382150xyz5	
160	225	450	382160xyz5	
180	250	450	382180xyz5	
200	300	500	382200xyz5	
225	300	500	382220xyz5	
250	350	550	382250xyz5	
300	400	600	382300xyz5	
350	450	650	382350xyz5	
400	500	700	382400xyz5	
450	550	750	382450xyz5	
500	600	800	382500xyz5	

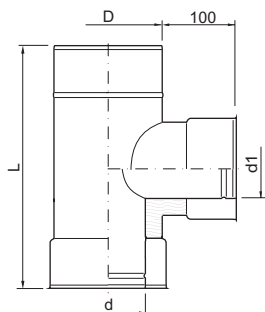

**TRÓJNIK REDUKCYJNY**
**381**

d	D	d1	A	L	INDEKS
120	200	350	500	381120xyz5	
130	200	350	500	381130xyz5	
140	200	350	500	381140xyz5	
150	225	400	570	381150xyz5	
160	225	400	570	381160xyz5	
180	250	410	570	381180xyz5	
200	300	500	700	381200xyz5	
225	300	500	700	381220xyz5	
250	350	550	800	381250xyz5	
300	400	600	800	381300xyz5	
350	450	680	900	381350xyz5	
400	500	780	1000	381400xyz5	
450	550	780	1000	381450xyz5	
500	600	860	1100	381500xyz5	

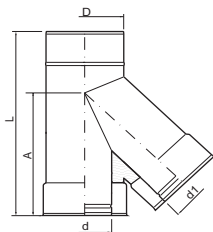
Zgodnie z zamówieniem

**KOLANO - TRÓJNIK 93°**
**383**

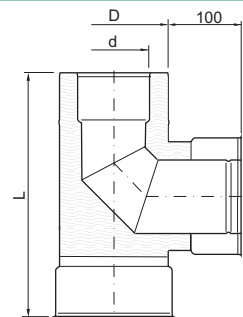
d	D	L	INDEKS
120	200	400	3831200005
130	200	400	3831300005
140	200	400	3831400005
150	225	450	3831500005
160	225	450	3831600005
180	250	450	3831800005
200	300	500	3832000005
225	300	500	3832200005
250	350	550	3832500005
300	400	600	3833000005
350	450	650	3833500005
400	500	700	3834000005
450	550	750	3834500005
500	600	800	3835000005



**PLYTA DO KOLANA - TRÓJNIK 93°**

**384**

d	D	A	INDEX
120	200	300	3841200005
130	200	300	3841300005
140	200	300	3841400005
150	225	300	3841500005
160	225	300	3841600005
180	250	D+100	3841800005
200	300	D+100	3842000005
225	300	D+100	3842200005
250	350	D+100	3842500005
300	400	D+100	3843000005
350	450	D+100	3843500005
400	500	D+100	3844000005
450	550	D+100	3844500005
500	600	D+100	3845000005

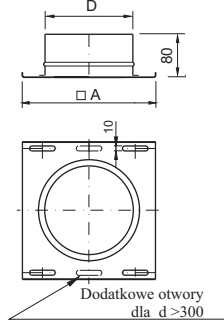

**ZAKOŃCZENIE RED. KIELICH - NYPEL**

**391**

d	D	INDEX
120	200	391120xyz5
130	200	391130xyz5
140	200	391140xyz5
150	225	391150xyz5
160	225	391160xyz5
180	250	391180xyz5
200	300	391200xyz5
225	300	391220xyz5
250	350	391250xyz5
300	400	391300xyz5
350	450	391350xyz5
400	500	391400xyz5
450	550	391450xyz5
500	600	391500xyz5

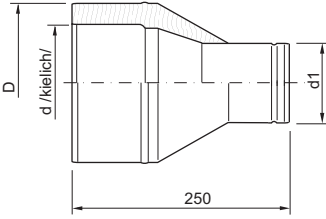

$d > d1$   $d_{max} = 2 * d1$   
 xyz /d1/ - średnica zgodnie z zamówieniem

**ZAKOŃCZENIE RED. KIELICH - KIELICH**

**392**

d	D	INDEX
120	200	392120xyz5
130	200	392130xyz5
140	200	392140xyz5
150	225	392150xyz5
160	225	392160xyz5
180	250	392180xyz5
200	300	392200xyz5
225	300	392220xyz5
250	350	392250xyz5
300	400	392300xyz5
350	450	392350xyz5
400	500	392400xyz5
450	550	392450xyz5
500	600	392500xyz5

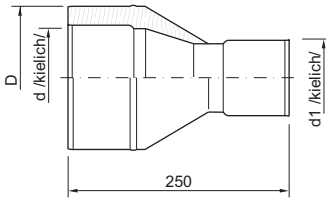

$d > d1$   $d_{max} = 2 * d1$   
 xyz /d1/ - średnica zgodnie z zamówieniem

**ZAKOŃCZENIE RED. NYPEL - KIELICH**

**393**

d	D	INDEX
120	200	393120xyz5
130	200	393130xyz5
140	200	393140xyz5
150	225	393150xyz5
160	225	393160xyz5
180	250	393180xyz5
200	300	393200xyz5
225	300	393220xyz5
250	350	393250xyz5
300	400	393300xyz5
350	450	393350xyz5
400	500	393400xyz5
450	550	393450xyz5
500	600	393500xyz5

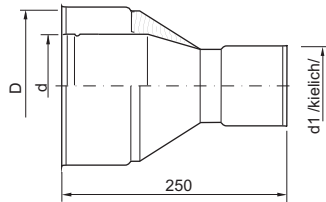

$d > d1$   $d_{max} = 2 * d1$   
 xyz /d1/ - średnica zgodnie z zamówieniem

**ZAKOŃCZENIE RED. NYPEL - NYPEL**

**394**

d	D	INDEX
120	200	394120xyz5
130	200	394130xyz5
140	200	394140xyz5
150	225	394150xyz5
160	225	394160xyz5
180	250	394180xyz5
200	300	394200xyz5
225	300	394220xyz5
250	350	394250xyz5
300	400	394300xyz5
350	450	394350xyz5
400	500	394400xyz5
450	550	394450xyz5
500	600	394500xyz5

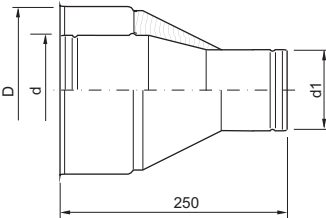

$d > d1$   $d_{max} = 2 * d1$   
 xyz /d1/ - średnica zgodnie z zamówieniem

**ELEMENT NIETYPOWY**

**999**

Elementy niekatalogowe wykonywane są na podstawie rysunków dostarczonych przez klienta. Wycena takich elementów jest oparta na indywidualnej kalkulacji.

**DEKIEL KIELICHOWY**

**385**

d	D	INDEX
120	200	3851200005
130	200	3851300005
140	200	3851400005
150	225	3851500005
160	225	3851600005
180	250	3851800005
200	300	3852000005
225	300	3852200005
250	350	3852500005
300	400	3853000005
350	450	3853500005
400	500	3854000005
450	550	3854500005
500	600	3855000005

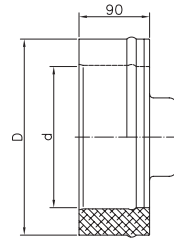

**ZAKOŃCZENIE RED. KIELICH - NYPEL TURBO**

**391**

d	D	INDEX
120	200	391120xyz5T
130	200	391130xyz5T
140	200	391140xyz5T
150	225	391150xyz5T
160	225	391160xyz5T
180	250	391180xyz5T
200	300	391200xyz5T
225	300	391220xyz5T
250	350	391250xyz5T
300	400	391300xyz5T

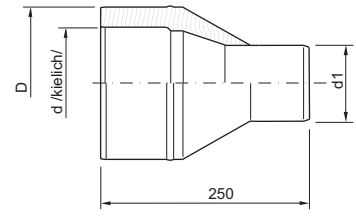

$d > d1$   $d_{max} = 2 * d1$   

d1	60	80	100	110	125	150
----	----	----	-----	-----	-----	-----

 xyz /d1/ - średnica zgodnie z zamówieniem

**ZAKOŃCZENIE RED. KIELICH - KIELICH TURBO**

**392**

d	D	INDEX
120	200	392120xyz5T
130	200	392130xyz5T
140	200	392140xyz5T
150	225	392150xyz5T
160	225	392160xyz5T
180	250	392180xyz5T
200	300	392200xyz5T
225	300	392220xyz5T
250	350	392250xyz5T
300	400	392300xyz5T

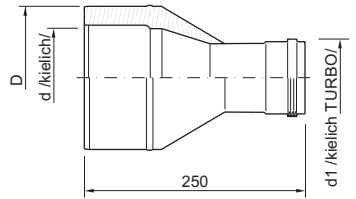

$d > d1$   $d_{max} = 2 * d1$   

d1	60	80	100	110	125	150
----	----	----	-----	-----	-----	-----

 xyz /d1/ - średnica zgodnie z zamówieniem

**ZAKOŃCZENIE RED. NYPEL - KIELICH TURBO**

**393**

d	D	INDEX
120	200	393120xyz5T
130	200	393130xyz5T
140	200	393140xyz5T
150	225	393150xyz5T
160	225	393160xyz5T
180	250	393180xyz5T
200	300	393200xyz5T
225	300	393220xyz5T
250	350	393250xyz5T
300	400	393300xyz5T

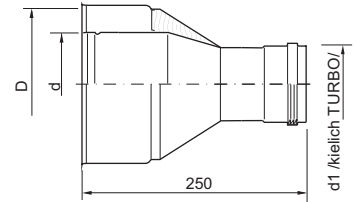

$d > d1$   $d_{max} = 2 * d1$   

d1	60	80	100	110	125	150
----	----	----	-----	-----	-----	-----

 xyz /d1/ - średnica zgodnie z zamówieniem

**ZAKOŃCZENIE RED. NYPEL - NYPEL TURBO**

**394**

d	D	INDEX
120	200	394120xyz5T
130	200	394130xyz5T
140	200	394140xyz5T
150	225	394150xyz5T
160	225	394160xyz5T
180	250	394180xyz5T
200	300	394200xyz5T
225	300	394220xyz5T
250	350	394250xyz5T
300	400	

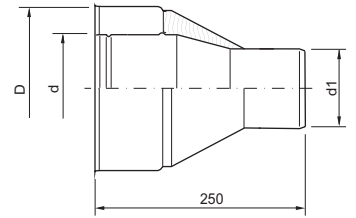

$d > d1$   $d_{max} = 2 * d1$   

d1	60	80	100	110	125	150
----	----	----	-----	-----	-----	-----

 xyz /d1/ - średnica zgodnie z zamówieniem