

PRZEWODY KOMINOWE TYPU DWWż INVEST

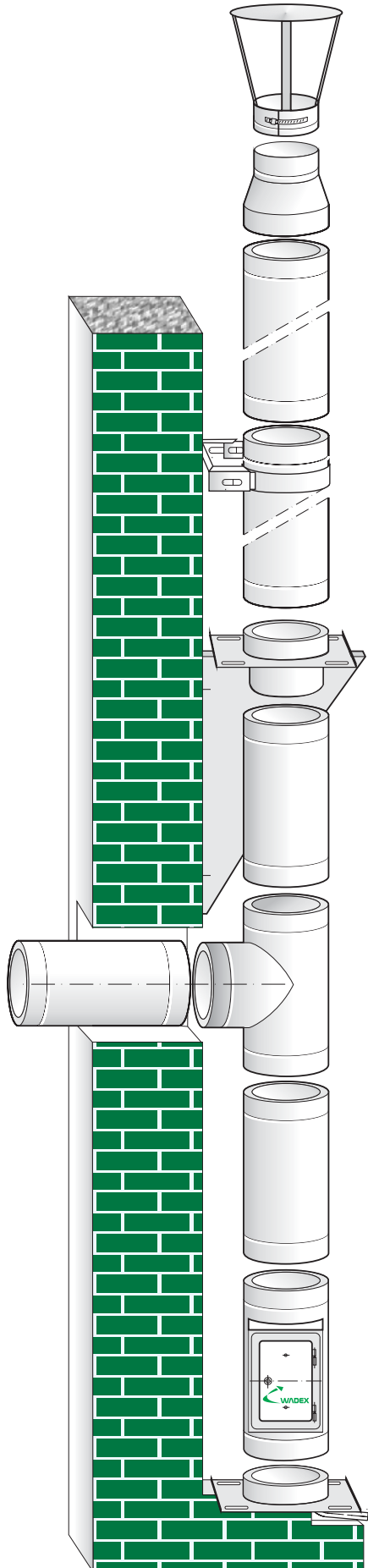

PRZEZNACZENIE:

stosowany jako komin zewnętrzny w celu odprowadzenia spalin na zewnątrz budynku z urządzeń grzewczych opalanych drewnem lub ekologicznymi paliwami stałymi o maksymalnej temperaturze spalin 600°C;

BUDOWA RUR I KSZTAŁTEK:

elementy dwuścienne izolowane wełną ceramiczną grubości 25 mm

ZAKRES ŚREDNIC:

130/180 ÷ 400/450 mm

PALIWO:

drewno lub ekologiczne paliwa stałe

GATUNEK I GRUBOŚĆ MATERIAŁU:

stal nierdzewna 1.4301 zaliczana do gatunku żaroodpornych o grubości 1 mm

ODPORNOŚĆ NA KOROZJĘ:

Vm / V3

ODLEGŁOŚĆ OD MATERIAŁÓW PALNYCH:

150 mm

KLASA TEMPERATURY:

T 600 - 600°C

SPOSÓB PRACY KOMINA:

podciśnieniowy

ODPORNOŚĆ NA DZIAŁANIE KONDENSATU:

D

USTNIK INVEST

450

d	D	INDEX
130	180	4501300007
150	200	4501500007
160	200	4501600007
180	225	4501800007
200	250	4502000007
250	300	4502500007
300	350	4503000007
350	400	4503500007
400	450	4504000007

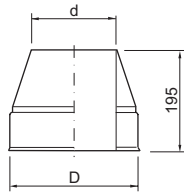

USTNIK POD PARASOL INVEST

451

d	D	INDEX
130	180	4511300007
150	200	4511500007
160	200	4511600007
180	225	4511800007
200	250	4512000007
250	300	4512500007
300	350	4513000007
350	400	4513500007
400	450	4514000007

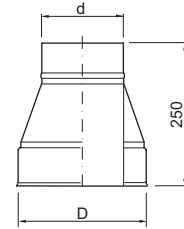

RURA INVEST

453, 454, 456

INDEX				
d	D	L 1000	L 500	L 250
130	180	4531300007	4541300007	4561300007
150	200	4531500007	4541500007	4561500007
160	200	4531600007	4541600007	4561600007
180	225	4531800007	4541800007	4561800007
200	250	4532000007	4542000007	4562000007
250	300	4532500007	4542500007	4562500007
300	350	4533000007	4543000007	4563000007
350	400	4533500007	4543500007	4563500007
400	450	4534000007	4544000007	4564000007

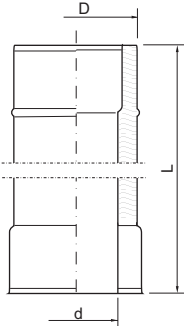

TRÓJNIK 93° INVEST

457

d	D	L	INDEX
130	180	400	4571300007
150	200	400	4571500007
160	200	400	4571600007
180	225	450	4571800007
200	250	450	4572000007
250	300	500	4572500007
300	350	550	4573000007
350	400	600	4573500007
400	450	650	4574000007

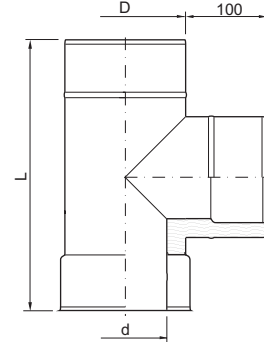

TRÓJNIK 45° INVEST

480

d	D	A	L	INDEX
130	180	350	500	4801300007
150	200	350	500	4801500007
160	200	350	500	4801600007
180	225	400	570	4801800007
200	250	400	570	4802000007
250	300	500	700	4802500007
300	350	550	800	4803000007
350	400	600	800	4803500007
400	450	680	900	4804000007

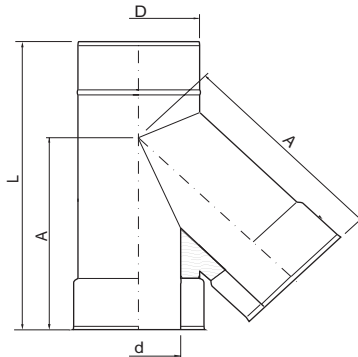

KOLANO 45° INVEST

465

d	D	A	INDEX
130	180	130	4651300007
150	200	135	4651500007
160	200	135	4651600007
180	225	140	4651800007
200	250	160	4652000007
250	300	195	4652500007
300	350	205	4653000007
350	400	215	4653500007
400	450	240	4654000007

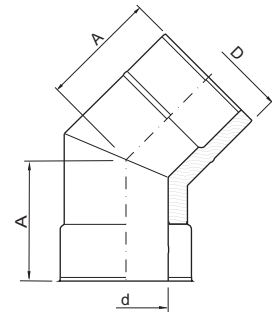

WYCZYSTKA INVEST

461

d	D	INDEX
130	180	4611300007
150	200	4611500007
160	200	4611600007
180	225	4611800007
200	250	4612000007
250	300	4612500007
300	350	4613000007
350	400	4613500007
400	450	4614000007

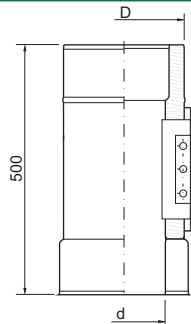

KOLANO 93° INVEST

466

d	D	A	INDEX
130	180	170	4661300007
150	200	180	4661500007
160	200	180	4661600007
180	225	200	4661800007
200	250	215	4662000007
250	300	230	4662500007
300	350	260	4663000007
350	400	300	4663500007
400	450	315	4664000007

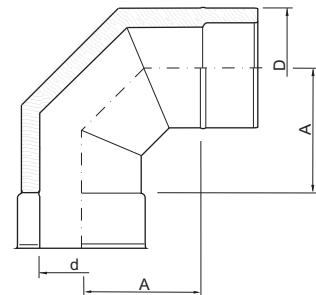

PODPORA PRZEJŚCIOWA INVEST

462

d	D	A	INDEX
130	180	300	4621300007
150	200	300	4621500007
160	200	300	4621600007
180	225	350	4621800007
200	250	350	4622000007
250	300	400	4622500007
300	350	450	4623000007
350	400	500	4623500007
400	450	550	4624000007

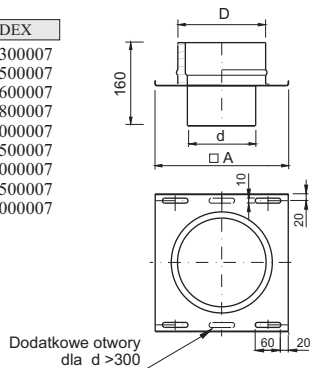

ODSKRAPLACZ INVEST

464

d	D	A	INDEX
130	180	300	4641300007
150	200	300	4641500007
160	200	300	4641600007
180	225	350	4641800007
200	250	350	4642000007
250	300	400	4642500007
300	350	450	4643000007
350	400	500	4643500007
400	450	550	4644000007

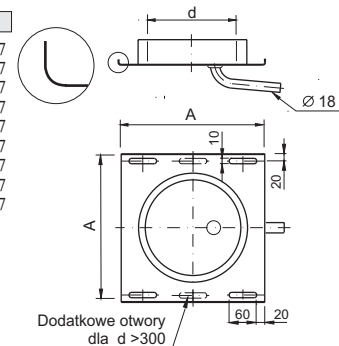

ZAKOŃCZENIE NYPEL-KIELICH INVEST 471

d	D	INDEX
130	180	4711300007
150	200	4711500007
160	200	4711600007
180	225	4711800007
200	250	4712000007
250	300	4712500007
300	350	4713000007
350	400	4713500007
400	450	4714000007

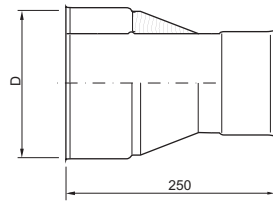

REDUKCJA ODWROTNA INVEST 476

d	D	INDEX
130	180	476130xyz7
150	200	476150xyz7
160	200	476160xyz7
180	225	476180xyz7
200	250	476200xyz7
250	300	476250xyz7
300	350	476300xyz7
350	400	476350xyz7
400	450	476400xyz7

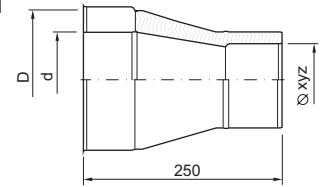

d>xyz d_{max}=2*xyz

ZAKOŃCZENIE NYPEL-NYPEL INVEST 474

d	D	INDEX
130	180	4741300007
150	200	4741500007
160	200	4741600007
180	225	4741800007
200	250	4742000007
250	300	4742500007
300	350	4743000007
350	400	4743500007
400	450	4744000007

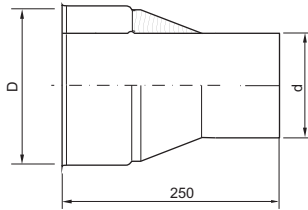

ZAKOŃCZENIE KIELICH-KIELICH INVEST 477

d	D	INDEX
130	180	4771300007
150	200	4771500007
160	200	4771600007
180	225	4771800007
200	250	4772000007
250	300	4772500007
300	350	4773000007
350	400	4773500007
400	450	4774000007

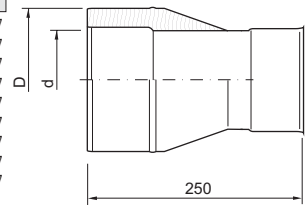

REDUKCJA INVEST 475

d	D	INDEX
130	180	475130xyz7
150	200	475150xyz7
160	200	475160xyz7
180	225	475180xyz7
200	250	475200xyz7
250	300	475250xyz7
300	350	475300xyz7
350	400	475350xyz7
400	450	475400xyz7

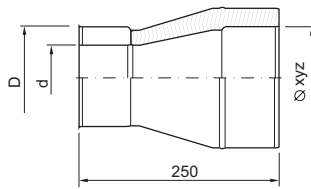

xyz>d xyz_{max} = 2*d

ZAKOŃCZENIE KIELICH-NYPEL INVEST 478

d	D	INDEX
130	180	4781300007
150	200	4781500007
160	200	4781600007
180	225	4781800007
200	250	4782000007
250	300	4782500007
300	350	4783000007
350	400	4783500007
400	450	4784000007

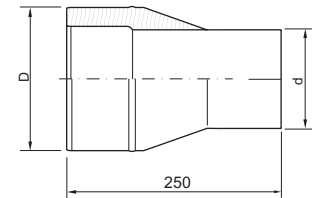

PRZEDŁUŻKA DO KOMINA INVEST 463

d	D	A	L	INDEX	
130	180	320	1280	780	4631300007
150	200	320	1280	780	4631500007
160	200	320	1280	780	4631600007
180	225	320	1280	780	4631800007
200	250	400	1280	780	4632000007
250	300	450	1280	780	4632500007

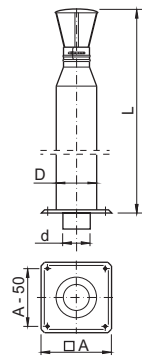

Dla L=1280 indeks jest np.. 463 130 0007
a dla L=780 indeks jest 463 130 1007

KOLANO Z WYCZYSTKĄ OKRĄGLĄ INVEST 452

d1	d	D	A	INDEX
130	130	180	180	4521300007
	150	200	180	4521500007
	160	200	180	4521600007
180	180	225	200	4521800007
	200	250	215	4522000007
	250	300	230	4522500007
200	300	350	255	4523000007
	350	400	300	4523500007
	400	450	315	4524000007

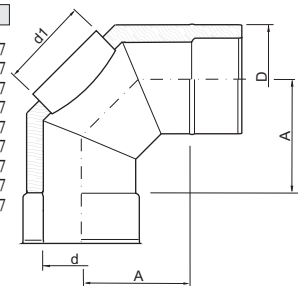

KOLANO 60° INVEST 473

d	D	A	INDEX
130	180	140	4731300007
150	200	145	4731500007
160	200	145	4731600007
180	225	160	4731800007
200	250	170	4732000007
250	300	195	4732500007
300	350	205	4733000007
350	400	215	4733500007
400	450	240	4734000007

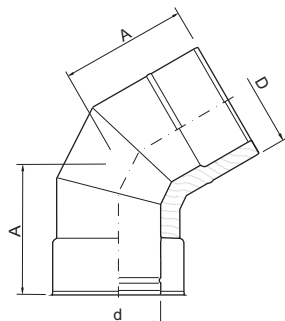

KOLANO 30° INVESTz 472

d	D	A	INDEX
130	180	130	4721300007
150	200	135	4721500007
160	200	135	4721600007
180	225	140	4721800007
200	250	160	4722000007
250	300	195	4722500007
300	350	205	4723000007
350	400	215	4723500007
400	450	240	4724000007

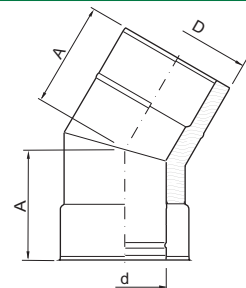

KOLANO 15° INVEST

484

d	D	A	INDEX
130	180	130	4841300007
150	200	135	4841500007
160	200	135	4841600007
180	225	140	4841800007
200	250	160	4842000007
250	300	195	4842500007
300	350	205	4843000007
350	400	215	4843500007
400	450	240	4844000007

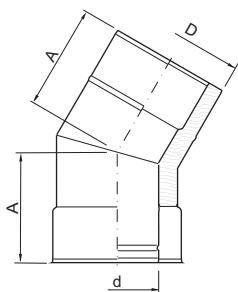

TRÓJNIK 93° Z WYCZYSTKĄ INVEST

483

d	D	L	INDEX
130	180	500	4831300007
150	200	500	4831500007
160	200	500	4831600007
180	225	500	4831800007
200	250	500	4832000007
250	300	500	4832500007
300	350	550	4833000007
350	400	600	4833500007
400	450	650	4834000007

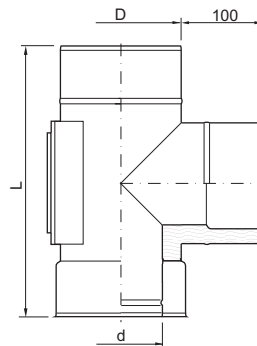

TRÓJNIK REDUKCYJNY 93° INVEST

459

d	D	INDEX
130	180	459130xyz7
150	200	459150xyz7
160	200	459160xyz7
180	225	459180xyz7
200	250	459200xyz7
250	300	459250xyz7
300	350	459300xyz7
350	400	459350xyz7
400	450	459400xyz7

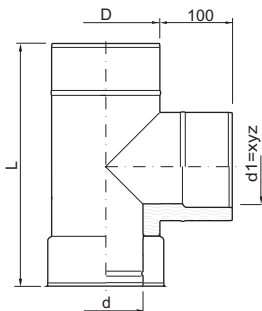

d>d1

d1	130	150	160	180	200	250	300	350
D1	180	200	200	225	250	300	350	400
L		400		450		500	550	600

TRÓJNIK 45° Z WYCZYSTKĄ INVEST

479

d	D	A	L	INDEX
130	180	350	500	4791300007
150	200	350	500	4791500007
160	200	350	500	4791600007
180	225	400	570	4791800007
200	250	400	570	4792000007
250	300	500	700	4792500007
300	350	550	800	4793000007
350	400	600	800	4793500007
400	450	680	900	4794000007

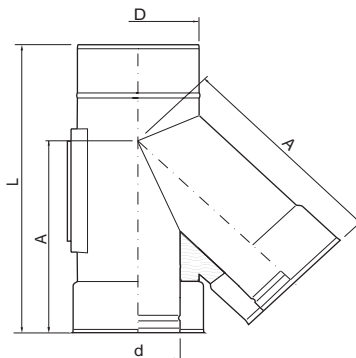

TRÓJNIK REDUKCYJNY 45° INVEST

460

d	D	INDEX
130	180	460130xyz7
150	200	460150xyz7
160	200	460160xyz7
180	225	460180xyz7
200	250	460200xyz7
250	300	460250xyz7
300	350	460300xyz7
350	400	460350xyz7
400	450	460400xyz7

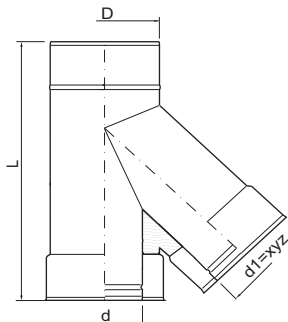

d1	130	150	160	180	200	250	300	350
D1	180	200	200	225	250	300	350	400
L		500		570		700	800	800

d>d1

REDUKCJA DWUNYPLOWA INVEST

482

d	D	INDEX
130	180	482130xyz7
150	200	482150xyz7
160	200	482160xyz7
180	225	482180xyz7
200	250	482200xyz7
250	300	482250xyz7
300	350	482300xyz7
350	400	482350xyz7
400	450	482400xyz7

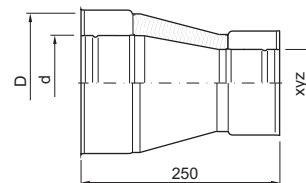

d>xyz d_{max} = 2*xyz

REDUKCJA DWUKIELICHOWA INVEST

481

d	D	INDEX
130	180	481130xyz7
150	200	481150xyz7
160	200	481160xyz7
180	225	481180xyz7
200	250	481200xyz7
250	300	481250xyz7
300	350	481300xyz7
350	400	481350xyz7
400	450	481400xyz7

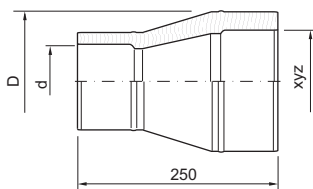

xyz>d xyz_{max} = 2*d

USTNIK POD NASADĘ KOMINOWĄ INVEST

451

d	D	INDEX
130	180	4511301007
150	200	4511501007
160	200	4511601007
180	225	4511801007
200	250	4512001007
250	300	4512501007
300	350	4513001007
350	400	4513501007
400	450	4514001007

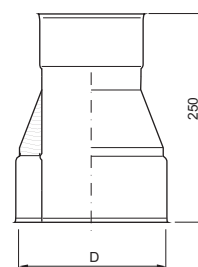

ZAKOŃCZENIE RED. KIELICH-NYPEL INVEST 485

d	D	INDEX
130	180	485130xyz7
150	200	485150xyz7
160	200	485160xyz7
180	225	485180xyz7
200	250	485200xyz7
250	300	485250xyz7
300	350	485300xyz7
350	400	485350xyz7
400	450	485400xyz7

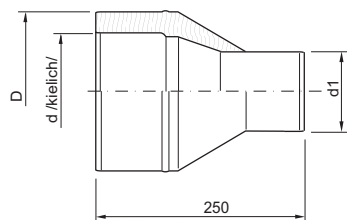

d>d1 d_{max}= 2*d1
xyz /d1/ - średnica zgodnie z zamówieniem

ZAKOŃCZENIE RED. NYPEL-NYPEL INVEST 487

d	D	INDEX
130	180	487130xyz7
150	200	487150xyz7
160	200	487160xyz7
180	225	487180xyz7
200	250	487200xyz7
250	300	487250xyz7
300	350	487300xyz7
350	400	487350xyz7
400	450	487400xyz7

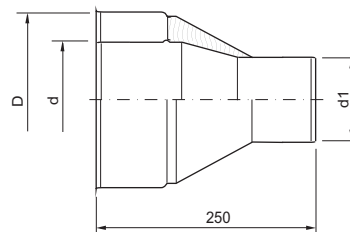

d>d1 d_{max} = 2*d1
xyz /d1/ - średnica zgodnie z zamówieniem

ZAKOŃCZENIE RED. KIELICH-KIELICH INVEST 486

d	D	INDEX
130	180	486130xyz7
150	200	486150xyz7
160	200	486160xyz7
180	225	486180xyz7
200	250	486200xyz7
250	300	486250xyz7
300	350	486300xyz7
350	400	486350xyz7
400	450	486400xyz7

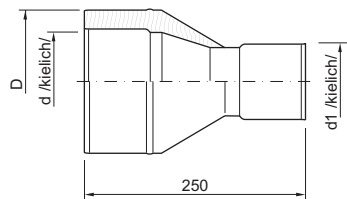

d>d1 d_{max}= 2*d1
xyz /d1/ - średnica zgodnie z zamówieniem

ZAKOŃCZENIE RED. NYPEL-KIELICH INVEST 488

d	D	INDEX
130	180	488130xyz7
150	200	488150xyz7
160	200	488160xyz7
180	225	488180xyz7
200	250	488200xyz7
250	300	488250xyz7
300	350	488300xyz7
350	400	488350xyz7
400	450	488400xyz7

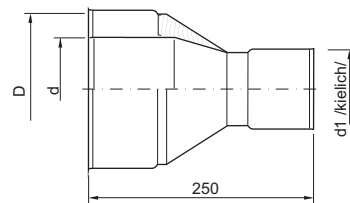

d>d1 d_{max}= 2*d1
xyz /d1/ - średnica zgodnie z zamówieniem

ELEMENT NIETYPOWY

999

Elementy niekatalogowe wykonywane są na podstawie rysunków dostarczonych przez klienta. Wycena takich elementów jest oparta na indywidualnej kalkulacji.